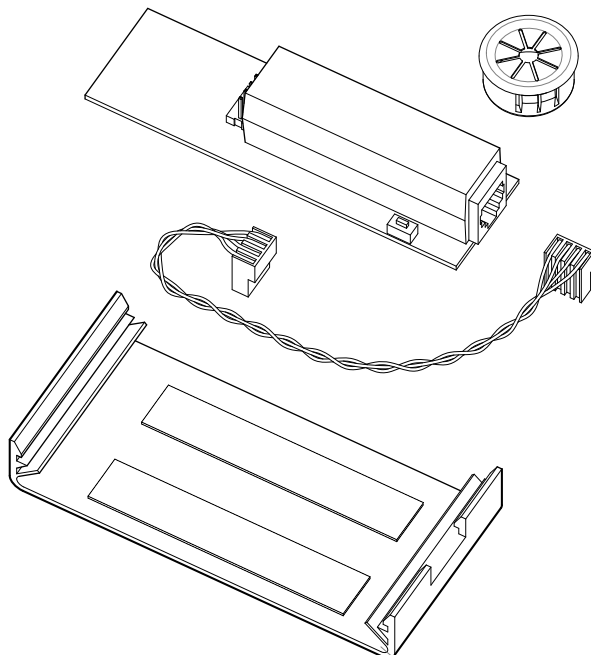
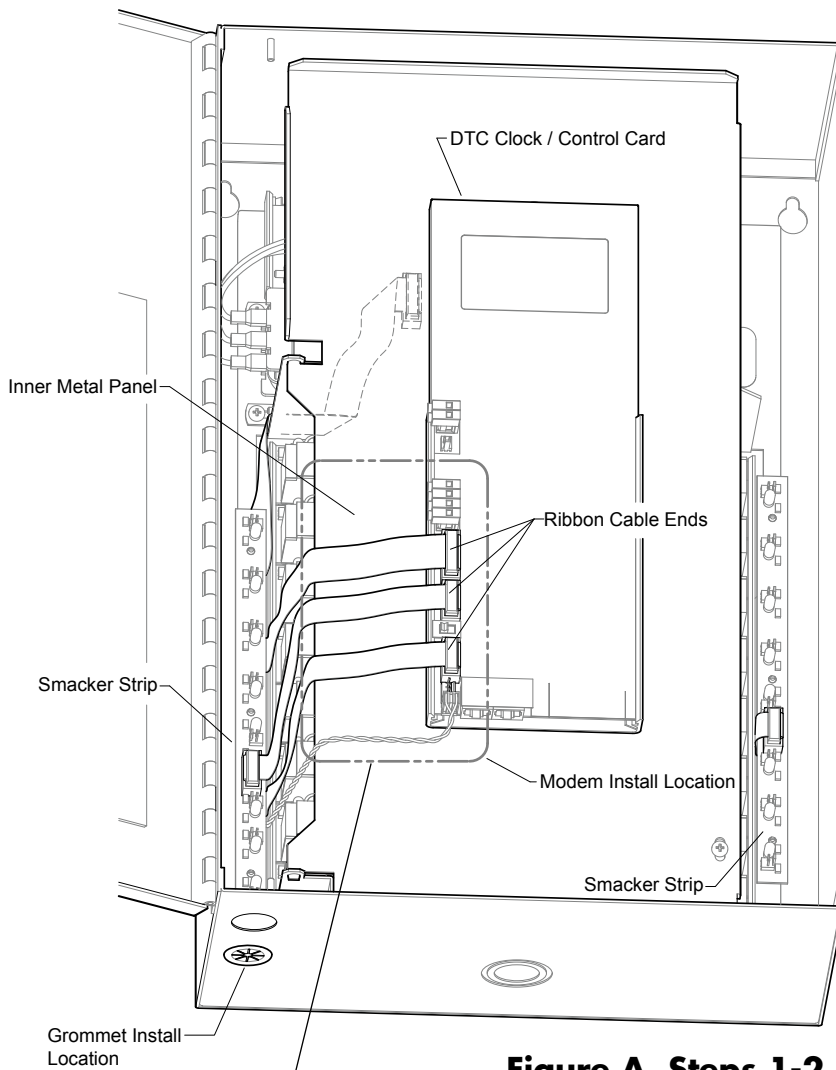


## INSTALLING THE EM-MOD

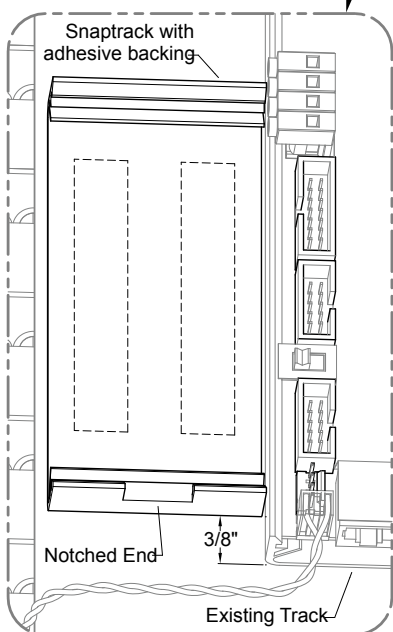
### Blue Box Modem Add-on Kit:

- Modem PC Board
- Modem Jumper Cable.
- Snaptrack (with adhesive backing)
- Grommet
- Installation Guide

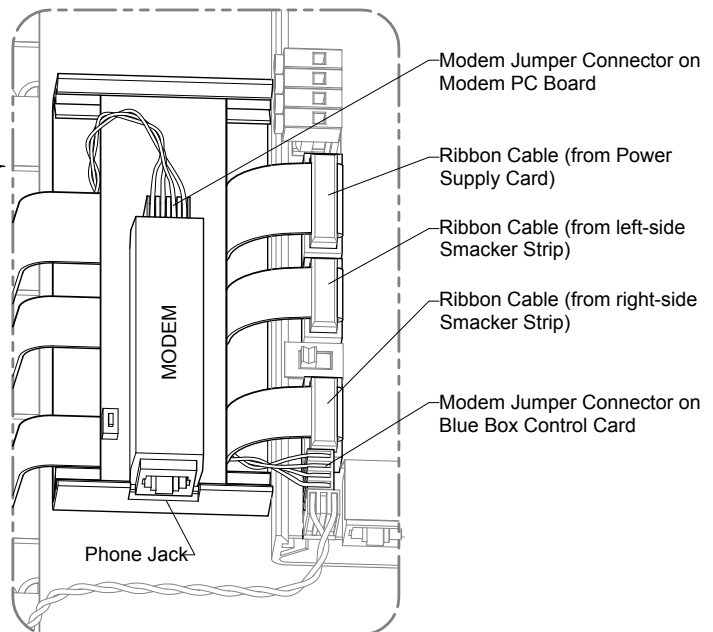




**Figure A, Steps 1-2**



**Figure B, Step 3**



**Figure C, Steps 4-8**

### Installing the BlueBox EM-MOD Modem Kit

1. Punch thru knockout and install the grommet at the bottom of enclosure as shown (see figure A).
2. Disconnect the ends of the three (3) ribbon cables indicated at the modem location (label cables to ensure they will be reconnected correctly) (see figure A).
3. Clean Snaptrack mounting surface and position as shown (*3/8" above bottom edge of existing track with notched end downward*). Attach to inner metal panel with adhesive backing, press firmly to ensure proper adhesion (see figure B).
4. Reconnect the three (3) ribbon cable ends to their proper connectors (see figure C).
5. Attach included Modem Jumper Cable to the connector on the Modem PC Board (see figure C).
6. Route the three (3) connected ribbon cables and the Modem Jumper Cable under the Modem PC Board, and snap the Modem PC Board into the Snaptrack as shown (see figure C).
7. Connect the remaining end of the Modem Jumper Cable onto the existing 4-pin female connector located just below the bottom ribbon cable connector on the Blue Box control card (see figure C).
8. Connect a dedicated, analog phone line to the modem phone jack. NOTE: The modem will not work properly with a digital phone line; ensure that a standard analog line is provided (see figure C).
9. Perform a Modem Check. NOTE: If you are unfamiliar with navigating through the DTC clock, and how to use the buttons, please refer to the Basic Programming Guide.

10. Follow this path in the DTC Clock: USER MENU > SETUP MENU > RESTRICTED (Password: 90001) > REMOTE SYSTEM MENU > DIAL UP HOST

**Factory setup is restricted!**  
**See manual or hit 'HELP' for details/**

**PASSWORD: 00000**

11. Using the SCROLL and TAB keys enter your cell phone number.
12. ENTER to select. You will not need to enter a password

**DIALING UP HOST**

**Enter the complete phone number of the HOST and hit enter.**

1 323 555 9999

13. ENTER to begin dialing. You should see this message.  
**Dialing HOST**  
**Please wait**
14. Screen will display modem status (no dial-tone, dialing, etc) which can be useful for trouble shooting the phone line. Feel free to contact Tech Support (800-345-4448 x 391) for trouble-shooting assistance.
15. Note the phone number of the modem as displayed on the caller ID of your cell phone: \_\_\_\_\_
16. EXIT 4 or 5 times until you are back at the main screen.



**INTERMATIC INCORPORATED, SPRING GROVE, IL 60081-9698**  
<http://www.intermatic.com>