

Professional Landscape Lighting by INTERMATIC®

TRANSFORMER INSTALLATION AND OPERATING INSTRUCTIONS

LOCATING AND INSTALLING YOUR TRANSFORMER

Once you have surveyed your property and determined where to place your accent lighting... such as along the walk, outlining the patio, etc., then...

1. Attach power cable to bottom of transformer with two terminal screw provided. See Fig. 1.
2. Hang raintight transformer within 1 foot of a standard grounded electrical outlet (115/125 Volt only). This product should be grounded. In the event of an electrical short circuit, grounding reduces the risk of electric shock by providing an escape wire with an appropriate grounding plug. The plug must be plugged into an outlet that is properly installed and grounded in accordance with all local codes and ordinances. Do not repair, or tamper with, this cord or plug without the assistance of an electrician or qualified serviceman. When mounted out-of-doors install transformer not less than one foot above ground with cable terminals down. See Fig. 2.
3. Plug transformer power cord into grounded outlet and turn transformer to "ON".
 - A. For transformers with automatic timers turn manual switch to "ON" or rotate dial so "ON" tripper passes time line indicator. See Fig. 3.
 - B. For manually operated models use "ON-OFF" switch. See Fig. 4.
4. Stretch power cable to full length. Route power cable where lights are desired. See Fig. 5.

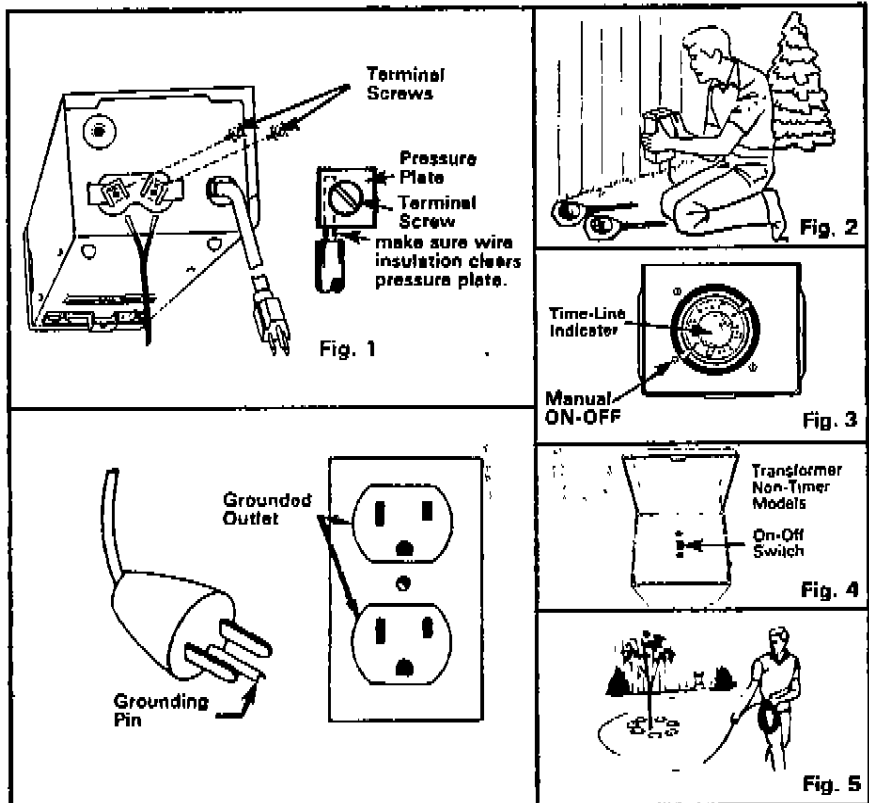

SUGGESTIONS TO SOLVE PROBLEMS QUICKLY

1. Make sure transformer is plugged in. Is outlet working?
2. Metal pierce terminals in the lamp housing and/or cable connector must be straight and must penetrate cable insulation in such a way to make contact with copper wire. If terminals are bent, straighten with pliers.
3. Make certain switch on transformer is in the "ON" position. For timer models rotate dial so "ON" tripper passes time-line indicator.
4. Is lamp burned out? Use another lamp to test.
5. If all lamps go out wait one full minute before pressing Mini Breaker button. Lamps should then light.

NOTE: This lighting system is designed to last for many years under normal conditions. However, like any other types, lamps eventually burn out and losing one can shorten the life of the others. Conditions beyond control (high input voltage, poor voltage regulation, etc.) will also affect lamp life. It is, therefore, important to replace a burned out lamp promptly.

