

Model CL22710TN  
SAVE THESE INSTRUCTIONS

INTERMATIC®  
**MALIBU**

www.intermatic.com

LT9

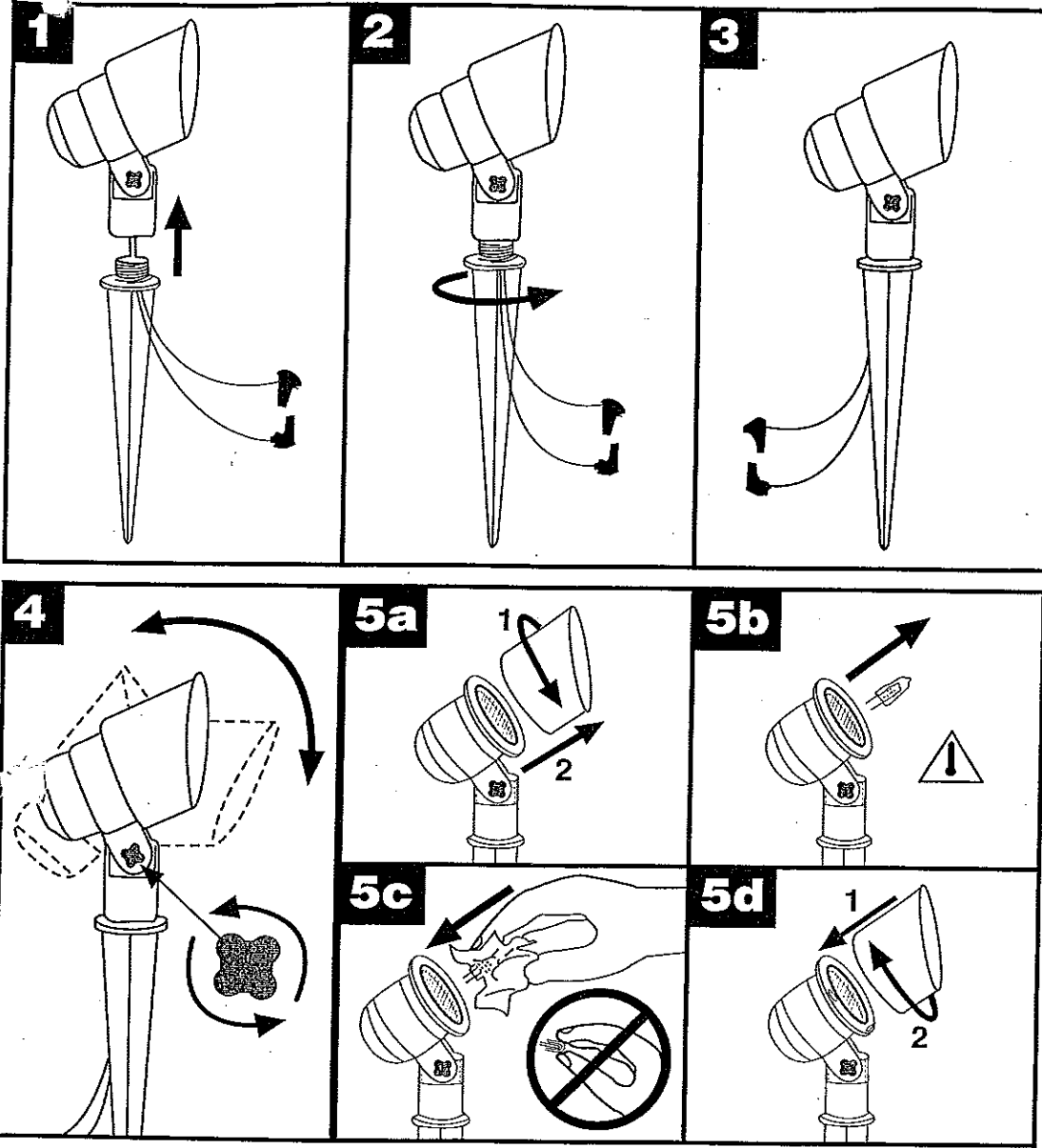

**WARNING:**  
Lens and  
shade get  
hot.

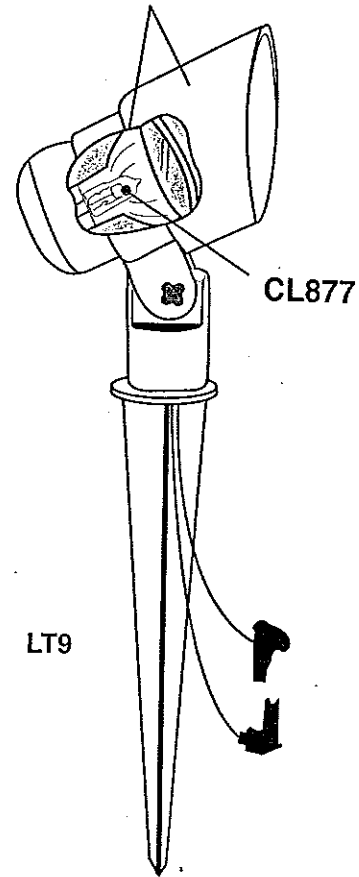

**IMPORTANT SAFETY INSTRUCTIONS**

**LIGHTED LAMP IS HOT!**

**WARNING: TO REDUCE THE RISK OF FIRE OR INJURY TO PERSONS:**

- Turn off/unplug and allow to cool before replacing lamp.
- Lamp gets **HOT** quickly! Contact only switch/ plug when turning on.
- Keep lamp away from materials that may burn.
- Do not touch the lamp at any time. Use a soft cloth. Oil from skin may damage lamp.
- Do not operate the luminaire fitting with a missing or damaged shield.
- The fixture wiring and connector are to be protected by routing in close proximity to the luminaire or fitting, or next to a building structure such as a house or deck. The wiring shall not be buried except for a maximum 3 inches in order to connect to the main secondary wire. The luminaires shall not be installed within 10 feet of a pool, spa, or fountain.

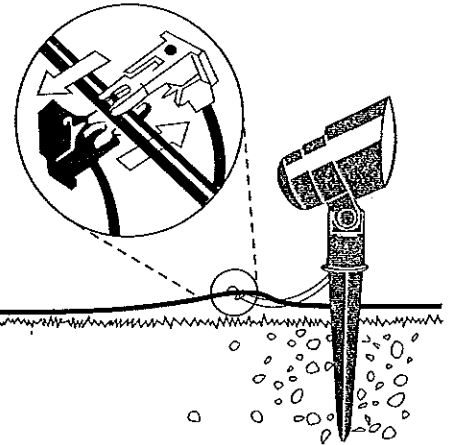

Do not touch hot lens: guard, shade, or enclosure.